

BauderTHERMOPLAN-T

Top-quality FPO waterproofing



Pitched roof systems



Flat-roof systems



Green roof systems

BauderTHERMOPLAN-T

The first choice when it comes to synthetics

Light roofs in industrial and low-height commercial buildings are generally waterproofed with synthetic roofing sheets. Just as for bitumen waterproofing, this is the case here as well: The quality of the system used is important.

BauderTHERMOPLAN-T is a modern FPO waterproofing system which is absolutely top class, setting standards in the fields of safety, easiness of installation and long life and has proved an outstanding product in many years of practical application.

These state of the art, high-quality, innovative flat roofing materials are manufactured to Bauder's proven quality and competence standards at the company's Bernsdorf works.

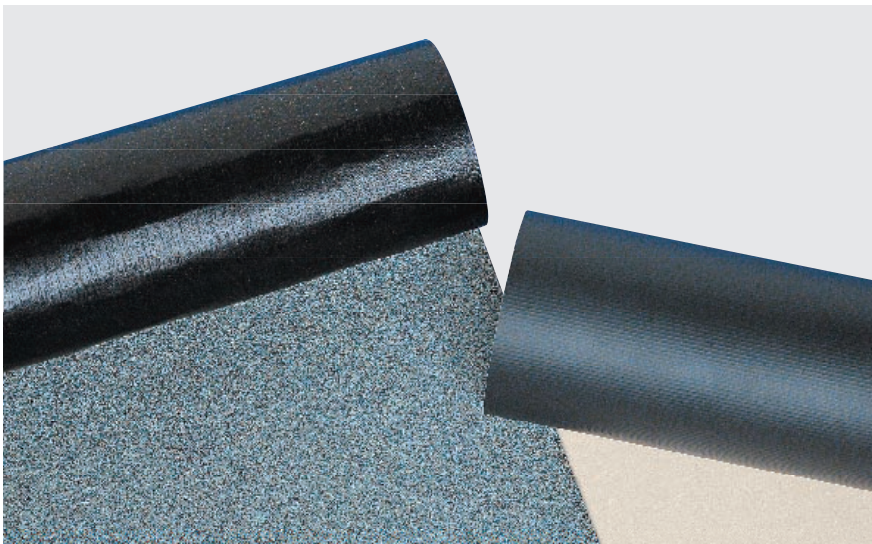

Bitumen and synthetics under one roof

As the first and only manufacturer of bituminous and synthetic waterproofing systems, Bauder's expertise in flat-roof production covers a variety of materials. Whether it's synthetic or bitumen, the flexibility of Bauder's systems solutions ensures that all requirements and customer wishes are met. For every conceivable waterproofing operation, product users and planners will find the optimum product to suit their needs, and from one and the same qualified source!

Just ask your Bauder specialist advisor!



Reliable and rapid seam closure

The 380-480 °C wide welding window makes the hot air welding of BauderTHERMOPLAN-T a safe operation. All seams can be closed with a high degree of safety and without risk of burning.

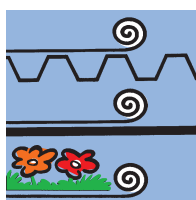

Versatility of use

BauderTHERMOPLAN-T is suitable for all light roof substructures, whether for new-build operations, renovation or roof greening. The sheets are bitumen-compatible and resistant to root penetration in accordance with FLL guidelines.

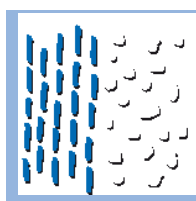

Permanent protection

BauderTHERMOPLAN-T is UV-stable and weather and age resistant. The high-quality FPO sheets will protect the roof for many years - whether as an exposed waterproofing or under superimposed loads such as gravel, terrace slabs or a green roof.



Ecological and easily reusable

As an FPO system without volatile plasticizers, BauderTHERMOPLAN-T is emission-free and can be welded without generating smoke or odours. Following decades of service as a waterproofing, the sheets can be recycled or put to thermal re-use without residues.



Complete in the system

BauderTHERMOPLAN-T sealing sheets are available in a number of thicknesses, thus enabling different requirements to be reliably met. The extensive range of system accessories makes the task of application easy and enables complete customised solutions to be created.

Roof construction with BauderTHERMOPLAN-T

Simplicity and reliability in the system

Reliable protection thanks to a simple system structure:

The single-layer waterproofing with BauderTHERMOPLAN-T meets the requirements of all current standards and to some extent goes well beyond them. With their excellent material properties the high-quality FPO roofing sheets make reliable laying easy to accomplish in both new-build projects and renovation.

1 BauderTHERMOPLAN-T waterproofing sheets

The high-quality FPO synthetic roofing sheets are laid loose in a single layer and hot air welded at the seams. Wind suction protection is quick and reliable thanks to mechanical fixing or by superimposed load.

2 Fire protection layer

When mechanically fixed to combustible insulating materials (e.g. EPS thermal insulation) a fire protection layer is necessary.

3 Bauder vapour barriers

Depending on substructure and constructional requirements, non-tear vapour barriers are available in varying thicknesses as a system accessory.

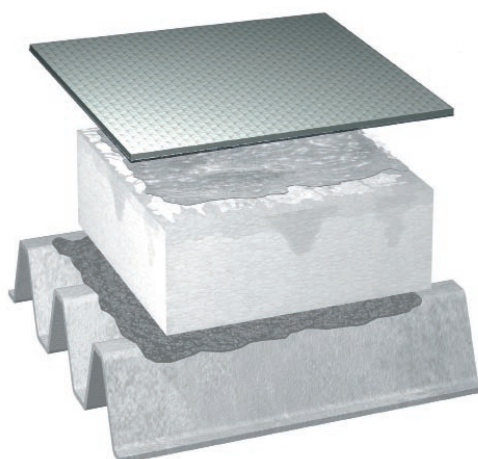
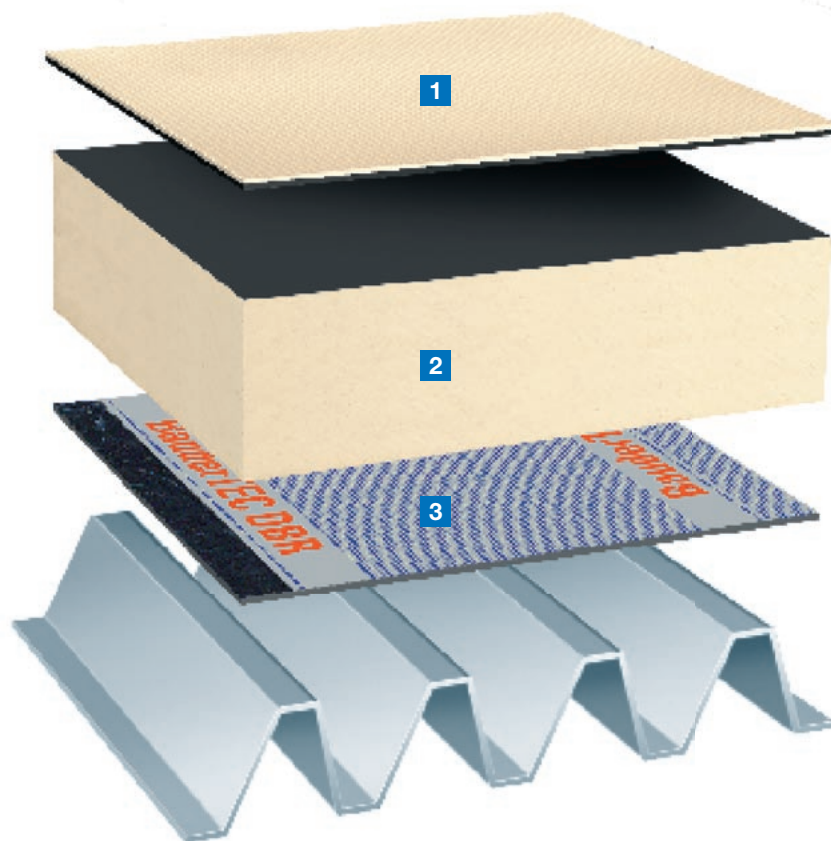

Roof renovation with BauderTHERMOPLAN-T

For many existing structures - including those with bitumen sheets - the BauderTHERMOPLAN-T SV 15 V special renovation sheet can be used. This FPO sheet is coated with non-woven fabric on the underside. PU adhesive is applied to the surface and it is hot air welded at the seams. Butt joints and transverse joints are butt-jointed and welded over with 20 cm wide strips of BauderTHERMOPLAN-T.

System structures with mechanically fixed waterproofing

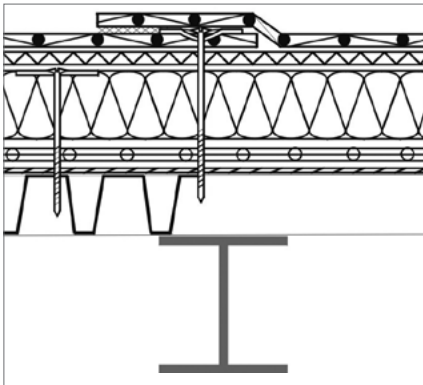

The waterproofing is mechanically fixed to the substructure right through the compression-resistant thermal insulation and then welded in the overlapping zone (in the case of EPS insulation panels and similar with a fire protection layer).

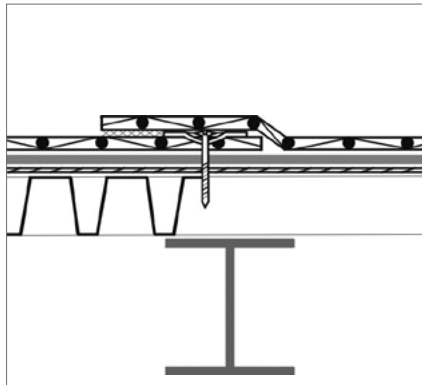

In the case of non-insulated roof structures mechanical fixing is done in the same way. With substructures made from steel trapezoidal sheet metal the waterproofing is laid on a laying aid (e.g. flat sheet) with an additional equalisation layer.

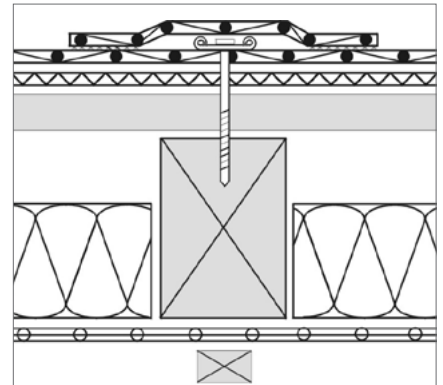

As an alternative to fixing in the overlapping zone, linear fixing is also possible using BauderTHERMOPLAN fixing bars, which are then welded over with sealing tapes from the relevant sheeting material.

System structures with superimposed load

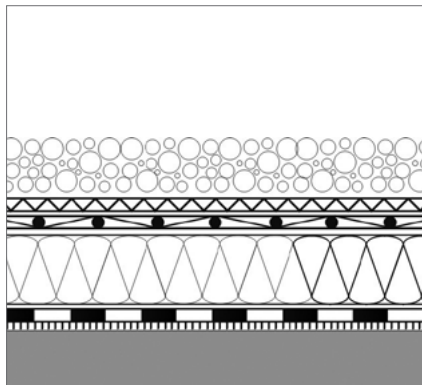

For the superimposed load a simple gravel surface may suffice in addition to a wear layer, such as terrace slabs or green roof. The waterproofing is seam welded, secured in position and protected against wind suction with at least 5 cm deep gravel filling.

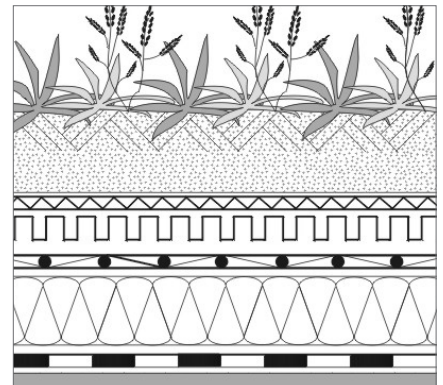

Bauder synthetic waterproofing sheets, which are robust and resistant to root penetration, are excellently suited to intensive and extensive green roofing. The plant structure serves at the same time as a protection against wind suction, thus making mechanical fixing unnecessary.

BauderTHERMOPLAN-T waterproofing sheets

Top class in any situation

No matter what the requirement

- weather resistance, chemical resistance or mechanical strength - when it comes to synthetics, the excellent properties of BauderTHERMOPLAN-T offer you virtually unlimited possibilities.

These versatile sealing sheets are available in three versions, depending on the intended use. Made from a particularly high-quality thermoplastic synthetic alloy of flexible polyolefins (FPO's), they contain no halogens, plasticisers or heavy metals, meet the highest requirements and involve very little effort in the laying process. Their broad compatibility makes the need for additional separation layers unnecessary in practically every case.

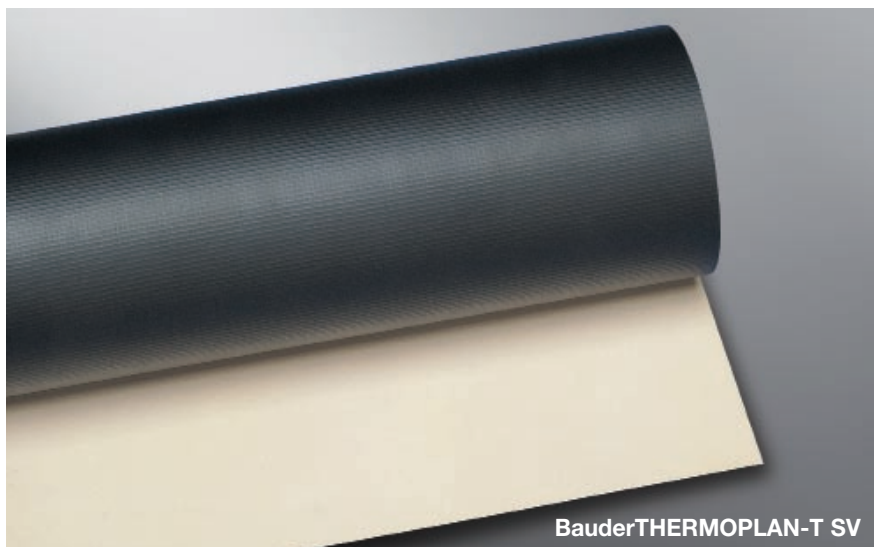

BauderTHERMOPLAN-T SV



A sheet with many strengths

BauderTHERMOPLAN-T SV combines dimensional stability, expandability and high mechanical strength with an excellent UV and temperature resistance. This means reliability in use and long life.

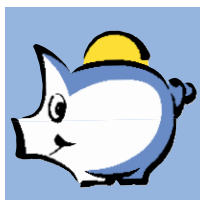

The easy way to save time and money

The fast and reliable manner of laying makes BauderTHERMOPLAN-T SV an economical solution for the new-build sector. The low weight of the waterproofing sheet makes site supply easier and reduces transport costs.

The sheet for flat-surface laying:

- BauderTHERMOPLAN-T SV with an extremely non-tear carrier insert
- cold-flexible to below -30 °C
- robust and long-lasting
- bitumen and polystyrene compatible
- resistant to root penetration in accordance with FLL guidelines



All BauderTHERMOPLAN-T waterproofing sheets are produced to the most modern manufacturing processes, using selected materials. Genuine top quality products when it comes to synthetics!

BauderTHERMOPLAN-T SV - Technical data		
Colour	Upper surface - pearl-white	
Material	FPO	
Carrier insert	Synthetic fibre	
Thickness	1.2 mm	1.5 / 1.8 / 2.0 mm
Dimension of roll	1.5 x 25 m	1.5 x 20 m

BauderTHERMOPLAN-T TL 15 - Technical data		
Colour	Upper surface - pearl-white	
Material	FPO	
Carrier insert	-	
Thickness	1.5 mm	
Dimension of roll	0.5 x 20 m	1.5 x 20 m

BauderTHERMOPLAN-T SV 15 V - Technical data		
Colour	Upper surface - pearl-white	
Material	FPO, underside non-woven fabric	
Carrier insert	Synthetic fibre	
Thickness	1.5 mm / total 2.5 mm	
Dimension of roll	1.5 x 20 m	



BauderTHERMOPLAN-T TL

The sheet for transitions and openings

- rapid, simple constructional detail with the BauderTHERMOPLAN-T TL 15 carrierless waterproofing sheet
- adaptable to any shape
- cold-flexible to below -30 °C
- bitumen and polystyrene-compatible
- resistant to root penetration in accordance with FLL guidelines
- very high expandability (up to 800 %)



Extreme elasticity

BauderTHERMOPLAN-T TL 15 possesses not only an extreme expandability but also a high degree of “shapability” without any return to the original shape. The sheet is, therefore, easy to work with in detail sections and is ideal for sealing openings of any size.



BauderTHERMOPLAN-T SV 15 V

The sheet for roof renovation work on synthetics and bitumen:

- BauderTHERMOPLAN-T SV 15 V with special non-woven fabric on the underside
- ideal for synthetic and bitumen roof renovation
- Fixing on a flat surface with protection against wind suction (in accordance with Bauder applications technology recommendations)
- robust and durable
- resistant to root penetration in accordance with FFL guidelines
- without non-woven fabric edge for simple seam welding



Renovation without additional separation layer

The non-woven fabric coated underside of BauderTHERMOPLAN-T SV 15 V acts both as an integrated separation layer and a vapour barrier equalisation layer. Undesirable interactions and the adhesion of the sealing to the existing building structure are effectively prevented. The additional work for laying the separation layer is unnecessary.



Paul Bauder GmbH & Co. KG
Korntaler Landstraße 63
D-70499 Stuttgart
Telephone 0711/88 07-0
Fax 0711/88 07-300
stuttgart@bauder.de

www.bauder.de

All the information contained in this leaflet is based on the information current at the time of printing. We reserve the right to make changes. If necessary, please check on technical developments when you place your order.

0128/1108 engl DW